

- Legend**
- Tabular
  - Traffic controller
  - Sign Stand
  - Work Area

Date: 11/9/2016 Author: Traffic King Ent Project: Sandpiper-Chilliwack - Hodgkins Ave

7:30am - 7pm

**Comments:**

- Work will take place between 7pm and 5pm
- While work takes place the west bound lane on Hodgkins Ave Traffic will be single lane alternating in the east bound lane
- "No Parking" signs will be placed where needed prior to work beginning
- TCP's will ensure they are aware of all emergency vehicles at all times
- access will be maintained to hospital AT ALL TIMES
- Tcps will be aware of pedestrians and cyclists at all times
- All signs and traffic control devices are to comply with MOT Manual for Work on Roadways



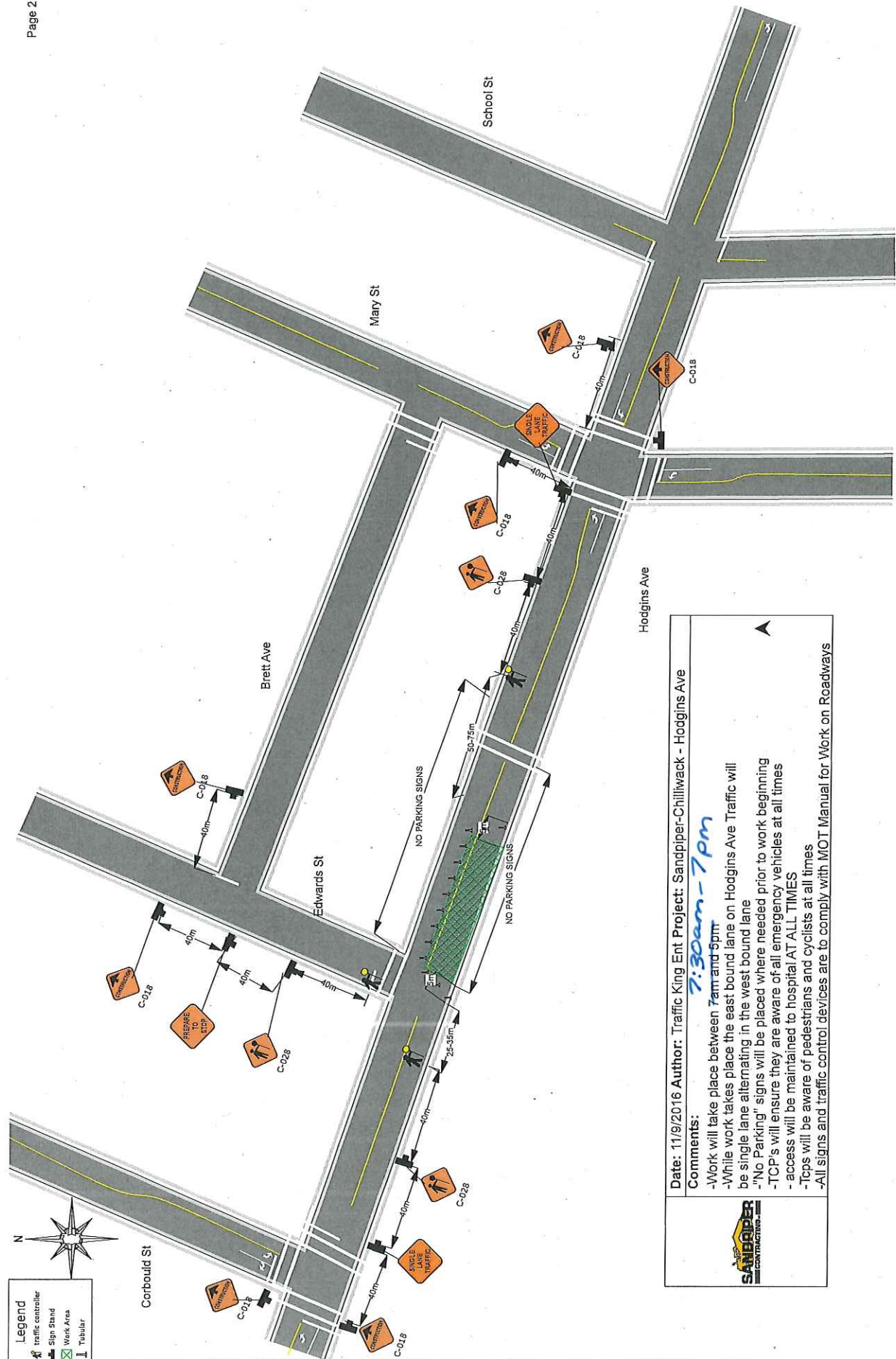

**Date:** 11/9/2016 **Author:** Traffic King Ent Project: Sandpiper-Chilliwack - Hodgins Ave

**Comments:**  
*7:30am - 7pm*  
 -Work will take place between 7am and 5pm  
 -While work takes place the east bound lane on Hodgins Ave Traffic will be single lane alternating in the west bound lane  
 -"No Parking" signs will be placed where needed prior to work beginning  
 -TCP's will ensure they are aware of all emergency vehicles at all times  
 -access will be maintained to hospital AT ALL TIMES  
 -Tcps will be aware of pedestrians and cyclists at all times  
 -All signs and traffic control devices are to comply with MOT Manual for Work on Roadways

